

Power distribution and
control solutions

CROUSE-HINDS
SERIES

CEAG GHG25

Safety Switch and Switch Disconnect



EATON

Powering Business Worldwide

Introducing CEAG GHG25 Safety Switch and Switch Disconnecter

Eaton's Crouse-Hinds series CEAG GHG25 safety switch and switch disconnecter are designed to provide safe and reliable performance in a wide range of harsh and hazardous area applications within oil and gas, petrochemical, chemical and other heavy industries.

The new series of GHG25 safety switches and switch disconnectors brings higher switching and isolation capacities, improved safety features and modular set-up delivering more protection for your personnel and operations in Ex environments.

The GHG25 safety switches and switch disconnectors feature full AC-3 motor switching capacities and isolating properties, an installation-friendly design, and easily accessible connection terminals. Available in fibreglass-reinforced polyester and stainless steel enclosures, our GHG25 portfolio provides excellent corrosion resistance, impact strength, and IP66 protection.

Look to Eaton for all your harsh and hazardous area switches

Eaton's Crouse-Hinds series portfolio features a broad range of switches for global harsh, hazardous, and industrial environments. Available in a variety of high-quality materials, along with a wide range of sizes, certifications and design options, Eaton can deliver a switch solution that meets your specific application requirements.



CEAG GHG26
For Zone 1 & 2 gas applications



CEAG GHG981
For Zone 22 dust applications



CEAG GHG981
For industrial applications



EID Disconnect switch
For Class I, Division 1 & 2
and Zone 1 & 2
hazardous applications

To browse our full portfolio of switches, please visit [eaton.com/switches](https://www.eaton.com/switches)

CEAG GHG25 safety switches and switch disconnectors

Design features:

Improved safety:

- Ensure safe operations of electrical devices during maintenance, cleaning and repair work
- Lockable in "OFF" position with three padlocks
- AC-3 and DC-23 switching capacity for isolating the electrical power supply of devices and other electrically operated equipment during maintenance, cleaning and repair work
- IEC/EN 62626-1 Class 1 compliant. Interlocked design prevents cover from being opened during maintenance

Rugged design that's built to last in harsh and hazardous areas:

- Certified as factory assembled to ATEX and IECEX standards
- Operating temperature range of -55°C to +55°C for Gas Group IIC
- Cover threads can be easily removed and replaced if damaged. No need to replace the entire switch

Installation-friendly design:

- Easily accessible connection terminals due to lower side walls on enclosure
- Optional mounting plate for simplified installation to wall, pipe or trellis
- Mounting plate and canopy simply clip on to switch - no tools required

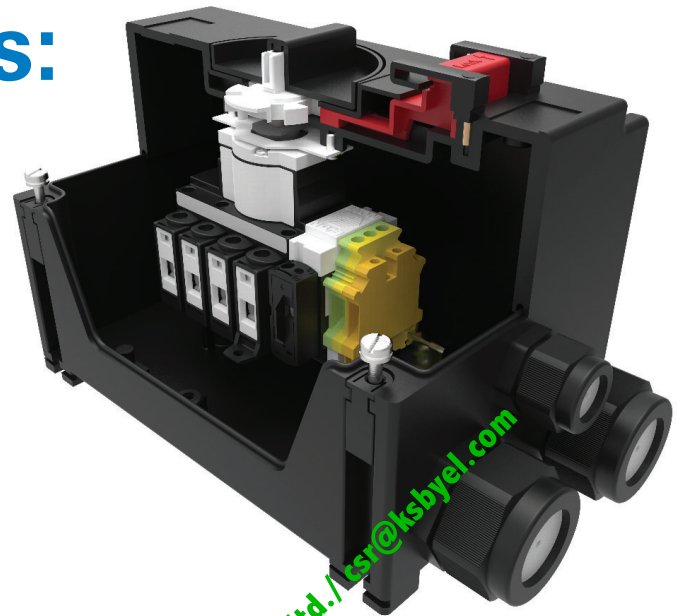

Excellent resistance to environmental challenges:

- High impact and corrosion resistant fibreglass-reinforced polyester or stainless-steel enclosures
- High degree of protection IP66
- Optional canopy provides additional protection from rain and sun exposure



Mounting plates



Protective canopy

Our GHG25's advanced switchblock improves safety and performance

Approved to the latest International standards:

- Certified as a component to ATEX and IECEX standards

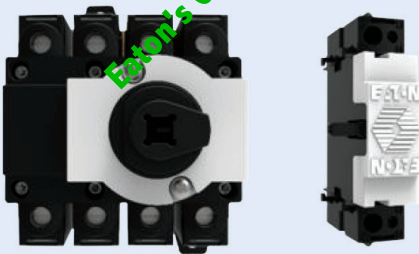

Engineered for safety:

- Higher isolation and motor switching capacities (AC-3 and DC 23)
- Auxiliary contacts close after the main contacts close and open before main contacts open
- Finger-safe IP20 devices and accessories

Simplified installation:

- Retrofittable auxiliary contacts can be easily installed in the field
- Switchblock modularity allows for easy extension to a 6-pole and 8-pole design
- Rail mounting

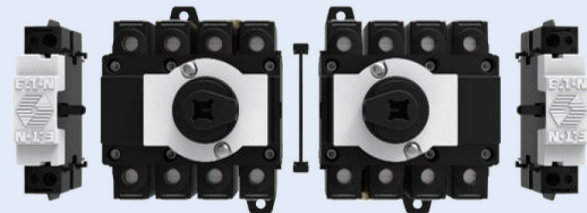

Flexible termination:

- Terminals with max 16 mm² wire cross section connection offers wide usage possibilities

CEAG GHG25 safety switches and switch disconnectors

Applications:

- Provides motor control and disconnect protection for Zone 1, 2, 21 and 22 hazardous areas
- Isolates the power supply on electrical installations and apparatus during maintenance, cleaning and repair work
- Can be protected against inadvertent switching on by our integrated locking design with up to three padlocks in the OFF position
- High isolating and switching capacities for safer operations
- Designed for high-reliability in industrial areas: chemical plants, paint manufacturing plants and oil and gas refineries

Standards:

- IEC 60079-0 / EN IEC 60079-0 general requirements
- IEC 60079-1 / EN IEC 60079-1 flameproof requirements "d"
- IEC 60079-7 / EN IEC 60079-7 increased safety requirements "e"
- IEC 60079-31 / EN 60079 protection by enclosure "t"

Certificates and markings:

- BVS 20 ATEX E 094 X; IECEx BVS 20.0076 X
- ATEX marking:
II 2G Ex db eb IIC/IIB T6/T5/T4 Gb
II 2D Ex tb IIIC T80 °C Db
- IECEx marking:
Ex db eb IIC/IIB T6/T5/T4 Gb
Ex tb IIIC T80 °C Db

Dimensions and weights:

Enclosure type	A (mm)	B (mm)	C (mm)	X (mm)	Y (mm)	Weight (kg)
GRP Size 1	110	170	129	96	150	1.54
GRP Size 2	140	225	156	123 - 126	197	2.00
GRP Size 3	271	271	200	247	247	3.15
Stainless Steel Size 2	175	392.5	216	109.5	362.5	4.55
Stainless Steel Size 3	312.5	392.5	216	247	362.5	6.44

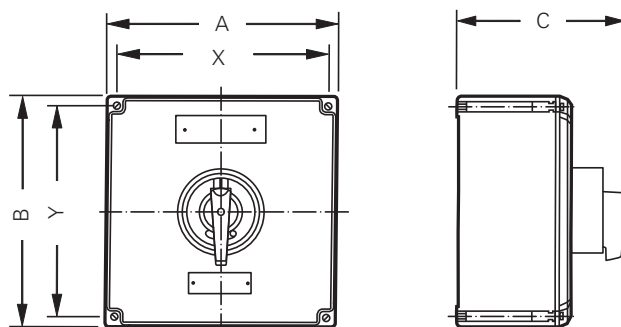

Representative switch



Standard materials and finishes:

- Enclosure – GRP black (Glass-Fibre Reinforced Polyester) or Stainless Steel (AISI 316L)
- Gasket – Silicone, foamed
- Lid screws – M4 / M6 captive screws (304 stainless steel)
- Mounting plates and protective canopies - Glass-Fibre Reinforced Polyester

Technical specifications:

- Ambient temperature range: -55 °C up to +55 °C
- 30,000 switching cycles electrical and mechanical lifetime
- Connecting terminals:
Main contact: 2 x 2.5 - 16 mm², 2 x 1.5 - 10 mm²
Auxiliary contact 1 NO: 1 x 0.5 - 2.5 mm² (pin cable lug),
1 x 2.5 - 16 mm²
Auxiliary contact: 1 x 0.5 - 2.5 mm², 2 x 0.5 - 1.5 mm²
- Environmental degree of protection: IP66
- High impact resistance: IK 09
- Enclosure mounting – 4 holes for M4 to M6 screws
- Retrofittable auxiliary contacts

Electrical ratings:

- Rated operating voltage (Ue): 690V - 50/60Hz; 60/120V DC
- Rated operating current (Ie): max 32A
- Back-up fuse 50A gG short circuit current limitation
- Isolating functions (IEC/EN 60947-3), AC-3, DC-23 switching capacity

CEAG GHG25 safety switches and switch disconnectors

Ordering details - Switch Disconnector:



Enclosure type	Cross section	Load			Auxiliary contact 1No ²	Enclosure material		Cable entries	Order No.
		20A	25 A	32 A		GRP	GRP + internal earth plate + stud		
Switch-disconnector 3-pole									
Size 1	2.5 mm ²	X			X	X		2x M32, 1x M25	GHG2521311R0303
Size 1	4.0 mm ²	X	X	X	X	X		2x M32, 1x M25	GHG2521312R0303
Size 2	6.0 mm ²	X	X	X	X	X		2x M32, 1x M25	GHG2521312R0303
Size 3	10.0 mm ²	X	X	X	X	X		2x M40, 1x M25	GHG2521313R0309
Size 3	16.0 mm ²	X	X	X	X	X		2x M40, 1x M25	GHG2521313R0309
Size 1	2.5 mm ²	X			X		X	2x M25, 1x M20	GHG2521311R0322
Size 1	4.0 mm ²	X	X	X	X		X	2x M25, 1x M20	GHG2521312R0322
Size 2	6.0 mm ²	X	X	X	X		X	2x M25, 1x M20	GHG2521312R0322
Size 3	10.0 mm ²	X	X	X	X		X	2x M32, 1x M20	GHG2521313R0328
Size 3	16.0 mm ²	X	X	X	X		X	2x M32, 1x M20	GHG2521313R0328
Size 2	2.5 mm ²	X	X		X			2x M25, 1x M20	GHG2521322R0341
Size 2	4.0 mm ²	X	X	X	X			2x M25, 1x M20	GHG2521322R0341
Size 2	6.0 mm ²	X	X	X	X			2x M25, 1x M20	GHG2521322R0341
Size 3	10.0 mm ²	X	X	X	X			2x M32, 1x M20	GHG2521323R0345
Size 3	16.0 mm ²	X	X	X	X			2x M32, 1x M20	GHG2521323R0345
Switch-disconnector 4-pole									
Size 1	2.5 mm ²	X				X		2x M32, 1x M25	GHG2521411R0003
Size 1	4.0 mm ²	X	X	X		X		2x M32, 1x M25	GHG2521411R0003
Size 2	6.0 mm ²	X	X	X		X		2x M32, 1x M25	GHG2521412R0003
Size 3	10.0 mm ²	X	X	X		X		2x M40, 1x M25	GHG2521413R0009
Size 3	16.0 mm ²	X	X	X		X		2x M40, 1x M25	GHG2521413R0009
Size 1	2.5 mm ²	X					X	2x M25, 1x M20	GHG2521411R0022
Size 1	4.0 mm ²	X	X	X			X	2x M25, 1x M20	GHG2521411R0022
Size 2	6.0 mm ²	X	X	X			X	2x M25, 1x M20	GHG2521412R0022
Size 3	10.0 mm ²	X	X	X			X	2x M32, 1x M20	GHG2521413R0028
Size 3	16.0 mm ²	X	X	X			X	2x M32, 1x M20	GHG2521413R0028
Size 2	2.5 mm ²	X	X					2x M25, 1x M20	GHG2521422R0041
Size 2	4.0 mm ²	X	X	X				2x M25, 1x M20	GHG2521422R0041
Size 2	6.0 mm ²	X	X	X				2x M25, 1x M20	GHG2521422R0041
Size 3	10.0 mm ²	X	X	X				2x M32, 1x M20	GHG2521423R0045
Size 3	16.0 mm ²	X	X	X				2x M32, 1x M20	GHG2521423R0045

² Auxiliary contact in main switch as NO

CEAG GHG25 safety switches and switch disconnectors

Ordering details - Switch Disconnecter:



Enclosure type	Cross section	Load			Auxiliary contact 1No ²	Enclosure material		Cable entries	Order No.
		20A	25 A	32 A		GRP	GRP + internal earth plate + stud		
Switch-disconnector 6-pole									
Size 3	2.5 mm ²	X	X			X			
Size 3	4.0 mm ²	X	X	X		X			
Size 3	6.0 mm ²	X	X	X		X		4x M32, 1x M20	GHG2521613R0002
Size 3	10.0 mm ²	X	X	X		X			
Size 3	16.0 mm ²	X	X	X		X			
Size 3	2.5 mm ²	X	X				X		
Size 3	4.0 mm ²	X	X	X			X		
Size 3	6.0 mm ²	X	X	X			X		
Size 3	10.0 mm ²	X	X	X			X		
Size 3	16.0 mm ²	X	X	X			X		
Size 3	2.5 mm ²	X	X					X	
Size 3	4.0 mm ²	X	X	X				X	
Size 3	6.0 mm ²	X	X	X				X	
Size 3	10.0 mm ²	X	X	X				X	
Size 3	16.0 mm ²	X	X	X				X	
Size 3	2.5 mm ²	X	X		X				
Size 3	4.0 mm ²	X	X	X	X	X			
Size 3	6.0 mm ²	X	X	X	X	X		4x M25, 1x M20	GHG2521613R0022
Size 3	10.0 mm ²	X	X	X	X	X			
Size 3	16.0 mm ²	X	X	X	X	X			
Size 3	2.5 mm ²	X	X		X				
Size 3	4.0 mm ²	X	X	X	X			X	
Size 3	6.0 mm ²	X	X	X	X			X	
Size 3	10.0 mm ²	X	X	X	X			X	
Size 3	16.0 mm ²	X	X	X	X			X	
Size 3	2.5 mm ²	X	X		X				
Size 3	4.0 mm ²	X	X	X	X				
Size 3	6.0 mm ²	X	X	X	X			X	
Size 3	10.0 mm ²	X	X	X	X			X	
Size 3	16.0 mm ²	X	X	X	X			X	

² Auxiliary contact in main switch as NO

CEAG GHG25 safety switches and switch disconnectors

Ordering details - Safety Switches:



Enclosure type	Cross section	Load			Auxiliary contact 1No ²	Enclosure material		Cable entries	Order No.
		20A	25 A	32 A		GRP	GRP + internal earth plate + stud		
Safety switch 3-pole									
Size 1	2.5 mm ²	X			X	X			
Size 1	4.0 mm ²	X	X	X	X	X		2x M32, 1x M25	GHG2522311R0303
Size 2	6.0 mm ²	X	X	X	X	X		2x M32, 1x M25	GHG2522312R0303
Size 3	10.0 mm ²	X	X	X	X	X			
Size 3	16.0 mm ²	X	X	X	X	X		2x M40, 1x M25	GHG2522313R0309
Size 1	2.5 mm ²	X			X		X		
Size 1	4.0 mm ²	X	X	X	X		X	2x M25, 1x M20	GHG2522311R0322
Size 2	6.0 mm ²	X	X	X	X		X	2x M25, 1x M20	GHG2522312R0322
Size 3	10.0 mm ²	X	X	X	X		X		
Size 3	16.0 mm ²	X	X	X	X		X	2x M32, 1x M20	GHG2522313R0328
Size 2	2.5 mm ²	X	X		X				X
Size 2	4.0 mm ²	X	X	X	X			2x M25, 1x M20	GHG2522322R0341
Size 2	6.0 mm ²	X	X	X	X				X
Size 3	10.0 mm ²	X	X	X	X				X
Size 3	16.0 mm ²	X	X	X	X			2x M32, 1x M20	GHG2522323R0345
EMERGENCY STOP 3-pole									
Size 1	2.5 mm ²	X			X	X			
Size 1	4.0 mm ²	X	X	X	X	X		2x M32, 1x M25	GHG2524311R0303
Size 2	6.0 mm ²	X	X	X	X	X		2x M32, 1x M25	GHG2524312R0303
Size 3	10.0 mm ²	X	X		X	X			
Size 3	16.0 mm ²	X	X	X	X	X		2x M40, 1x M25	GHG2524313R0309
Size 1	2.5 mm ²	X			X		X		
Size 1	4.0 mm ²	X	X	X	X		X	2x M25, 1x M20	GHG2524311R0322
Size 2	6.0 mm ²	X	X	X	X		X	2x M25, 1x M20	GHG2524312R0322
Size 3	10.0 mm ²	X	X	X	X		X		
Size 3	16.0 mm ²	X	X	X	X		X	2x M32, 1x M20	GHG2524313R0328
Size 2	2.5 mm ²	X	X		X				X
Size 2	4.0 mm ²	X	X	X	X			2x M25, 1x M20	GHG2524322R0341
Size 2	6.0 mm ²	X	X	X	X				X
Size 3	10.0 mm ²	X	X	X	X				X
Size 3	16.0 mm ²	X	X	X	X			2x M32, 1x M20	GHG2524323R0345

² Auxiliary contact in main switch as NO

CEAG GHG25 safety switches and switch disconnectors



Ordering details - Safety Switches:

Enclosure type	Cross section	Load			Auxiliary contact 1No ²	Enclosure material		Cable entries	Order No.
		20A	25 A	32 A		GRP	GRP + internal earth plate + stud		
EMERGENCY STOP 6-pole									
Size 3	2.5 mm ²	X	X		X	X			
Size 3	4.0 mm ²	X	X	X	X	X			
Size 3	6.0 mm ²	X	X	X	X	X	4x M32, 1x M20		GHG2522613R0302
Size 3	10.0 mm ²	X	X	X	X	X			
Size 3	16.0 mm ²	X	X	X	X	X			
Size 3	2.5 mm ²	X	X		X		X		
Size 3	4.0 mm ²	X	X	X	X		X		
Size 3	6.0 mm ²	X	X	X	X		X		
Size 3	10.0 mm ²	X	X	X	X		X		
Size 3	16.0 mm ²	X	X	X	X		X		
Size 3	2.5 mm ²	X	X		X			X	
Size 3	4.0 mm ²	X	X	X	X			X	
Size 3	6.0 mm ²	X	X	X	X			X	
Size 3	10.0 mm ²	X	X	X	X			X	
Size 3	16.0 mm ²	X	X	X	X			X	
Size 3	2.5 mm ²	X	X		X				X
Size 3	4.0 mm ²	X	X	X	X				X
Size 3	6.0 mm ²	X	X	X	X				X
Size 3	10.0 mm ²	X	X	X	X				X
Size 3	16.0 mm ²	X	X	X	X				X

Ordering details: Accessories:

Type	Description	Order No.
Auxiliary switches, coupling set and pin cable lugs		
Ex - d Aux switch	1 NC	GHG2593251R0001
Ex - d Aux switch	1 NO	GHG2593241R0001
Ex - d Aux switch	1 NO + 1 NC	GHG2593211R0001
Ex-i Upgrading kit		GHG2501903R0001
Coupling set for 2x switch blocks		GHG2501901R0001
Set of pin cable lugs for Aux	(2x 0.5 - 1mm ² , 2x 1.5 - 2.5mm ²)	GHG2501904R0001
Set of pin cable lugs for Aux	(10x 0.5 - 1mm ² , 10x 1.5 - 2.5mm ²)	GHG2501904R0002

Circuit diagrams

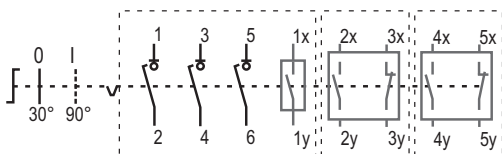

3pol. Main Switch c/w aux NO / optional aux / optional aux

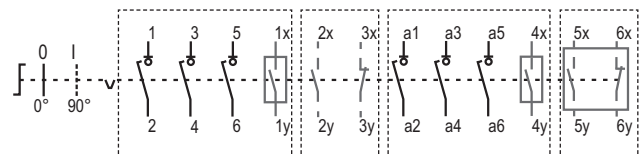

3pol. Main Switch c/w aux NO / optional aux / 3pol. Main Switch c/w aux NO / optional aux

CEAG GHG25 safety switches and switch disconnectors

Ordering details: Accessories:

Type	Fixing method	Order No.
Mounting plate for Size 1 safety switches and switch disconnectors		
Wall mounting	snap on	GHG6101953R0104
Pipe clamp	snap on	GHG6101953R0105
Trellis-work mounting	snap on	GHG6101953R0106
Mounting plate for Size 2 safety switches and switch disconnectors		
Wall mounting	snap on	GHG6101953R0118
Pipe clamp	snap on	GHG6101953R0110
Trellis-work mounting	snap on	GHG6101953R0118
Mounting plate for Size 3 safety switches and switch disconnectors		
Pipe clamp (2X)	screw-on	GHG6101953R0110



Mounting plate

Type	OU	Order No.
Mounting plate accessories		
Label holder with type label (blank) for mounting plate size 2 and 3	10	GHG6101953R0057
Mounting hardware for pipes 1" (Ø 27 - 30 mm) for pipe clamp mounting plates	10	GHG6101953R0020



Protective canopy
(Requires mounting plate for installation)

Type	Application notes	Order No.
Protective canopy - requires mounting plate for installation		
Canopy for size 1 safety switches and switch disconnectors		GHG6101955R0102
Canopy for size 2 safety switches and switch disconnectors	installs on pipe clamp mounting plates only	GHG6101955R0104
Canopy for size 3 safety switches and switch disconnectors		GHG6101955R0106

Dimensions: Mounting plates and canopies

For size 1 safety switches and switch disconnectors

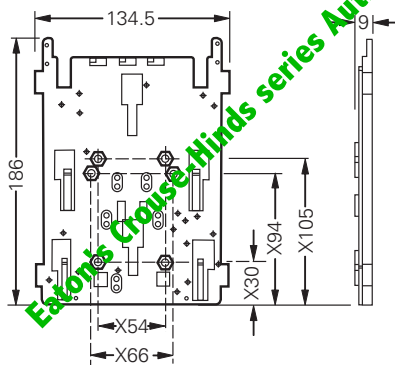

Mounting plate for wall/trellis mounting

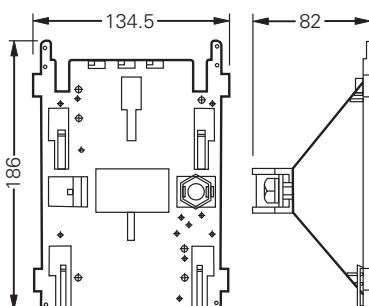

Mounting plate for pipe mounting

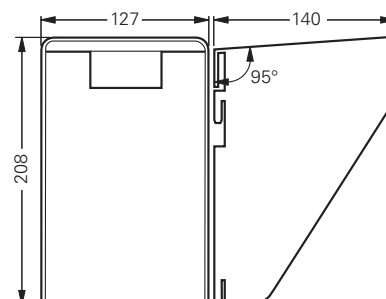

Protective canopy for wall, trellis and pipe clamp mounting plates

CEAG GHG25 safety switches and switch disconnectors

Dimensions: Mounting plates and canopies

For size 2 safety switches and switch disconnectors

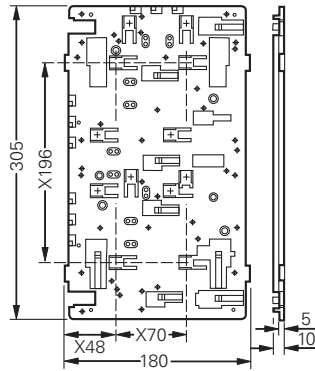

Mounting plate for wall/trellis mounting

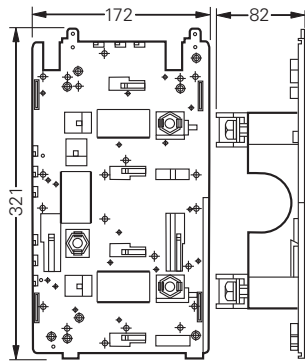

Mounting plate for pipe clamp mounting

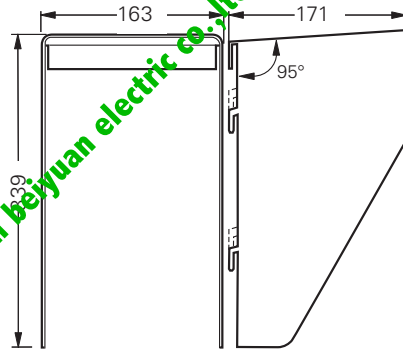

Protective canopy for pipe clamp mounting plates

For size 3 safety switches and switch disconnectors

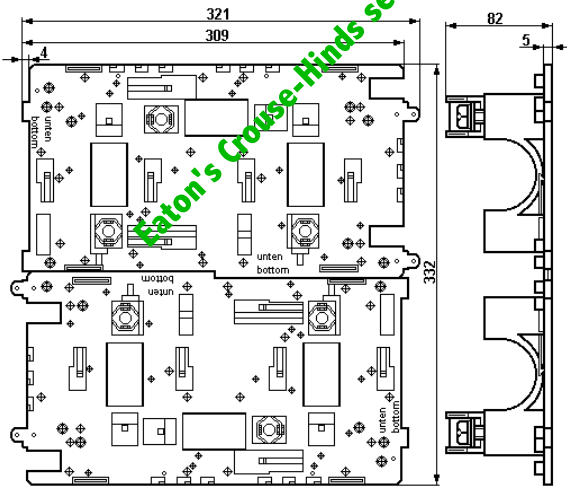

Mounting plate for pipe clamp mounting
(2 plates installed horizontally)

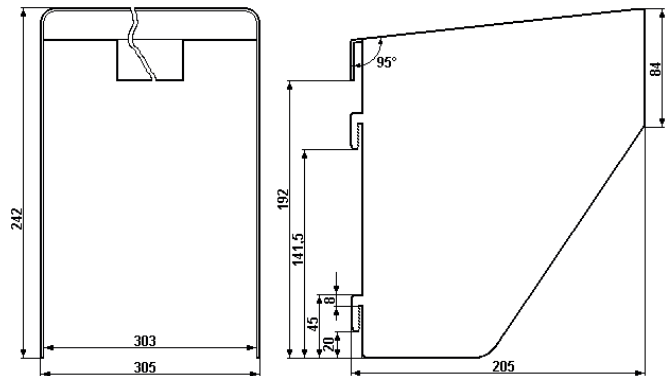

Protective canopy for pipe mounting plates