

Cable types:

Listed for use with:



- Flexible cords, including Type S, SO, STO, ST, SJ, SJT, SJTO and SVO
- Tray cable types P, TC, TC-ER, TC-ER-HL^A, ITC, ITC-ER, ITC-HL, PLTC and PLTC-ER cables

Features:

- Rugged, durable construction protects cords and cables from damage and compact design permits close grouping of several cords and/or cables
- Flexible offering available in steel, iron and aluminum in 1/2" to 3" trade sizes
- Wire mesh grips available for added strain relief
- Available with NPT threads
- Standard neoprene bushing weatherproof seal on outer sheath of cable

Certifications and compliances:

- cULus Listed – UL File No. E23223
- Suitable for use in Class I, Division 2 hazardous locations when installed in accordance with NEC501.10(B)(4)
- NEMA 3R (suitable for use in wet locations)
- NEMA 4 (1/2" to 3" steel only)
- NEMA 4X (1/2" to 1 1/2" aluminum only)

Standard materials and finishes:

- Bodies and gland nuts – steel with zinc electroplate and chromate finish coat
- Form E-F bodies and gland nuts – Feraloy[®] iron alloy with electrogalvanized and aluminum acrylic paint
- Available in all aluminum construction
- Bushing – standard silicone bushing included



Operating temperature:

- Tray cable/Type P: -40°C to +100°C
- Flexible cords: -40°C to +80°C

^AType TC-ER-HL cable is rated for 600V nominal. Overall cable diameters are 25mm (1") or less.

CGB non-armored cable glands

NEMA 3R, 4, 4X

1G

1G

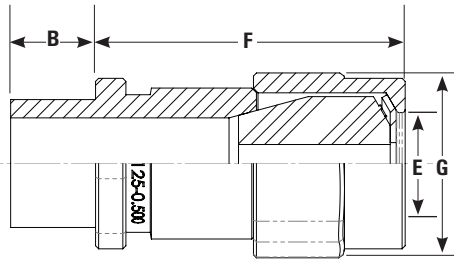

Options:

Description

- Sealing gasket and locknut..... **SG**

Suffix



Ordering information:



NPT thread size	Form	Cat. # Steel	Cat. # Aluminum	No. of bushings	Cable sealing range (E)		Dimensions		Across hex flats (G)	Across hex corners (G)	Optional Cat. # Wire mesh grip
					Min.	Max.	B	F			
1/2"	—	CGB2-050-0	CGB2-050-0-SA	1	0.180	0.250	0.560	1.200	1.160	1.260	—
1/2"	—	CGB2-050-1	CGB2-050-1-SA	1	0.250	0.375	0.560	1.200	1.160	1.260	—
1/2"	—	CGB2-050-2	CGB2-050-2-SA	1	0.375	0.437	0.560	1.200	1.160	1.260	—
3/4"	—	CGB2-075-0	CGB2-075-0-SA	1	0.180	0.250	0.570	1.200	1.160	1.260	—
3/4"	—	CGB2-075-1	CGB2-075-1-SA	1	0.250	0.375	0.570	1.200	1.160	1.260	—
3/4"	—	CGB2-075-2	CGB2-075-2-SA	1	0.375	0.500	0.570	1.200	1.160	1.260	—
1/2"	—	CGB2-050-3	CGB2-050-3-SA	3	0.500	0.875	0.560	1.200	1.660	1.800	—
3/4"	—	CGB2-075-3	CGB2-075-3-SA	3	0.500	0.875	0.570	1.200	1.660	1.800	—
1"	—	CGB2-100-0	CGB2-100-0-SA	3	0.500	0.875	0.700	1.400	1.660	1.800	—
1"	—	CGB2-100-1	CGB2-100-1-SA	3	0.875	1.375	0.700	1.480	2.340	2.520	—
1 1/2"	—	CGB2-125-0	CGB2-125-0-SA	3	0.875	1.375	0.730	1.480	2.340	2.520	—
1 1/4"	E	CGB4913	—	1	1.375	1.625	0.688	2.625	3.000 [Ⓟ]	—	RPE433-123
1 1/4"	E	CGB4915	—	1	1.625	1.875	0.688	2.625	3.000 [Ⓟ]	—	17317N
1 1/2"	D	CGB2-150-0	CGB2-150-0-SA	1	0.875	1.375	0.750	1.480	2.340	2.520	—
1 1/2"	E	CGB5913	—	1	1.375	1.625	0.813	2.625	3.000 [Ⓟ]	—	RPE433-123
1 1/2"	E	CGB5915	—	1	1.625	1.875	0.813	2.625	3.000 [Ⓟ]	—	17317N
2"	E	CGB6913	CGB6913 SA	1	1.375	1.625	0.813	2.625	3.000 [Ⓟ]	—	RPE433-123
2"	E	CGB6915	CGB6915 SA	1	1.625	1.875	0.813	2.625	3.000 [Ⓟ]	—	17317N
2"	F	CGB6917	—	1	1.875	2.188	0.813	2.563	3.813 [Ⓟ]	—	17345N
2"	F	CGB6920	—	1	2.188	2.500	0.813	2.563	3.813 [Ⓟ]	—	16772N
2 1/2"	E	CGB7913	CGB7913 SA	1	1.375	1.625	1.000	2.625	3.125 [Ⓟ]	—	RPE433-123
2 1/2"	E	CGB7915	CGB7915 SA	1	1.625	1.875	1.000	2.625	3.125 [Ⓟ]	—	17317N
2 1/2"	F	CGB7917	CGB7917 SA	1	1.875	2.188	1.438	2.625	3.875 [Ⓟ]	—	17345N
2 1/2"	F	CGB7920	—	1	2.188	2.500	1.438	2.625	3.875 [Ⓟ]	—	16772N
3"	F	CGB8917 [Ⓞ]	CGB8917 SA	1	1.875	2.188	1.438	2.625	3.875 [Ⓟ]	—	17345N
3"	F	CGB8920	CGB8920 SA	1	2.188	2.500	1.438	2.625	3.875 [Ⓟ]	—	16772N

All dimensions in inches.

[Ⓟ]Maximum operating temperature of bushing only; glands UL Listed to -25°C to +40°C with neoprene bushing.

[Ⓞ]Not NEMA 4 or 4X rated.

Cable types:

Listed for use with:

- Flexible cords, including Type S, SO, STO, ST, SJ, SJT, SJTO and SVO
- Tray cable types P, TC, TC-ER, TC-ER-HL ^A, ITC, ITC-ER, ITC-HL, PLTC and PLTC-ER cables



Features:

- Rugged, durable construction protects cords and cables from damage and compact design permits close grouping of several cords and/or cables
- Wire mesh grips available for added strain relief
- Available with NPT threads
- Standard neoprene bushing weatherproof seal on outer sheath of cable

Certifications and compliances:

- cULus Listed – UL File No. E23223
- Suitable for use in wet locations
- NEMA 4

Standard materials:

- Body – Feraloy® iron alloy
- Gland nut – steel

Operating temperature:

- Tray cable/Type P: -40°C to +100°C
- Flexible cords: -40°C to +80°C

Options:

Description

- Sealing gasket and locknut..... **SG**

Suffix

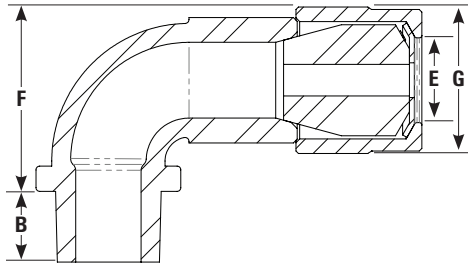

NPT thread size	Cat. #	No. of bushings	Cable sealing range (E)		Dimensions		
			Min.	Max.	B	F	G
1/2"	CGE2-050-0	3	0.180	0.500	0.56	1.46	1.16
1/2"	CGE2-050-1	3	0.500	0.875	0.56	2.00	1.66
3/4"	CGE2-075-0	3	0.180	0.500	0.57	1.50	1.16
3/4"	CGE2-075-1	3	0.500	0.875	0.57	2.00	1.66
1"	CGE2-100-0	3	0.500	0.875	0.70	2.13	1.66
1"	CGE2-100-1	3	0.875	1.375	0.70	2.80	2.34

All dimensions in inches.

^AType TC-ER-HL cable is rated for 600V nominal. Overall cable diameters are 25mm (1") or less.

Gland type:

- Non-armored

Cable type:

- Non-armored and tray cable

Features:

- Weatherproof seal on outer sheath of cable
- Available with NPT threads
- Refer to CGB2 for sizes less than 2" NPT

Certifications and compliances:

- Suitable for use in Class I, Division 2 hazardous locations when installed in accordance with NEC501.10(B)(2)

Standard materials:

- Form B-C bodies and gland nuts – turned steel
- Form D-G bodies and gland nuts – Feraloy® iron alloy

Operating temperature:

- -25°C to +40°C

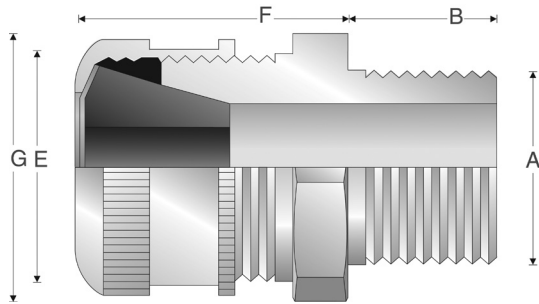

Ordering information:

Entry thread size (A)			Cable acceptance outer sheath				
NPT thread size	Cat. #	Form	NPT thread length (B)	Min.	Max.	Gland length less entry (F)	External diameter / hex (G)
2"	CGFP6913	E	1.000	1.375	1.625	3.250	3.250
2"	CGFP6915	E	1.000	1.625	1.875	3.250	3.250
2 1/2"	CGFP7917	F	1.438	1.875	2.188	3.250	3.875
2 1/2"	CGFP7920	F	1.438	2.188	2.500	3.250	3.875
3"	CGFP8917	F	1.500	1.875	2.188	3.250	3.875
3"	CGFP8920	F	1.500	2.188	2.500	3.250	3.875
3 1/2"	CGFP923	G	1.563	2.500	3.000	4.250	5.500
3 1/2"	CGFP927	G	1.563	3.000	3.500	4.250	5.500
4"	CGFP1023	G	1.625	2.500	3.000	4.250	5.500
4"	CGFP1027	G	1.625	3.000	3.500	4.250	5.500

All dimensions in inches.